

*Exciting opportunities.*

## *Refreshing times.*

At Acacia, it's a massive spread of exciting opportunities, swimming pool to throw your worries out and dive into cool waters, a gymnasium to break sweat, shuttle to work on that back hand, the toddlers' swimming pool to keep the kids occupied, the amphi-theatre to watch your favourite screenings, there's absolutely no lack of excitement. Acacia is built to cater to your every innate desire and transform you in every beautiful way possible. Come; step into the world Acacia and leave the worries of the world behind.

[www.ssvracacia.com](http://www.ssvracacia.com)

Promoters & Builders



### SSVR

RERA # : PRM/KA/RERA/1251/446/PR/190215/002373.  
Sy# . 72/1, 72/2 & 74/3, Panathur, marathahalli, Sarjapur,  
Outer Ring Road, Bangalore-560 103.  
Mob : 90359 19999, 95353 38196, 95353 38218.

Architects & Engineers



### S'N'S ASSOCIATES

ARCHITECTS & ENGINEERS

Bengaluru Off : Horamavu Road, Bengaluru. Cell:- +91 7795016269  
Hyderabad Off : Vidyanagar, Ph: 040-27666972, Cell:- +91 9848016269.  
e-mail: info@snsassociates.co.in, gksagarsns@gmail.com



A Project of



Classy standards.  
Envious living

SSVR

*Acacia*  
Live with nature

2 & 3 BHK LUXURY APARTMENTS @ PANATHUR BANGALORE



SSVR  
*Acacia*  
Live with nature



*Spaces of luxury and  
freedom*



When was the last time you felt like a master of your own kingdom? When was it, you felt you are living in a paradise surrounded with luxuries? When was it you felt your residence offers the privacy and luxury, you always dreamt of? Welcome to Acacia, where each aspect of your dream has been carefully crafted into this breathtaking project. Where every 2 BHK and 3 BHK is like a master vision unfolding, transforming your intricate dreams into tangible realities.



SSVR  
*Acacia*  
Live with nature

*Modernity*  
in nature's lap

Acacia - The beauty of this project is its green concepts. All elements are specifically crafted to fit into the contemporary mould which surprisingly is encircled with nature's bounty. Massive amounts of green areas are earmarked to offer residents lung space to enjoy life at its own pace. Undulated ventilation and sunshine; fresh green pockets, sweeping views of breathtaking sunrises and sunsets – in short, a house here is worth many elsewhere.

*Aerial View*



SSVR  
*Acacia*  
 Live with nature

*Amenities to keep you revitalized*

PROJECT HIGHLIGHTS

- |                   |                   |                   |
|-------------------|-------------------|-------------------|
| 1 Entrance        | 7 Gym             | 13 Amphitheatre   |
| 2 Down to Cellar  | 8 Indoor Games    | 14 Lawn           |
| 3 Ground Entrance | 9 Skating Rink    | 15 Lobby          |
| 4 Jogging Track   | 10 Swimming Pool  | 16 Shuttle Court  |
| 5 Walk Way        | 11 Toddler's Pool | 17 Cricket net    |
| 6 Party Hall      | 12 Gazebo         | 18 Kids Play Area |

Ground Floor Plan

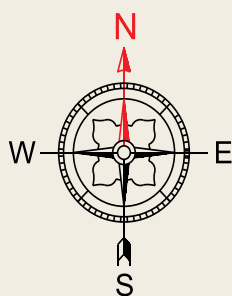

ROAD



Typical Floor Plan

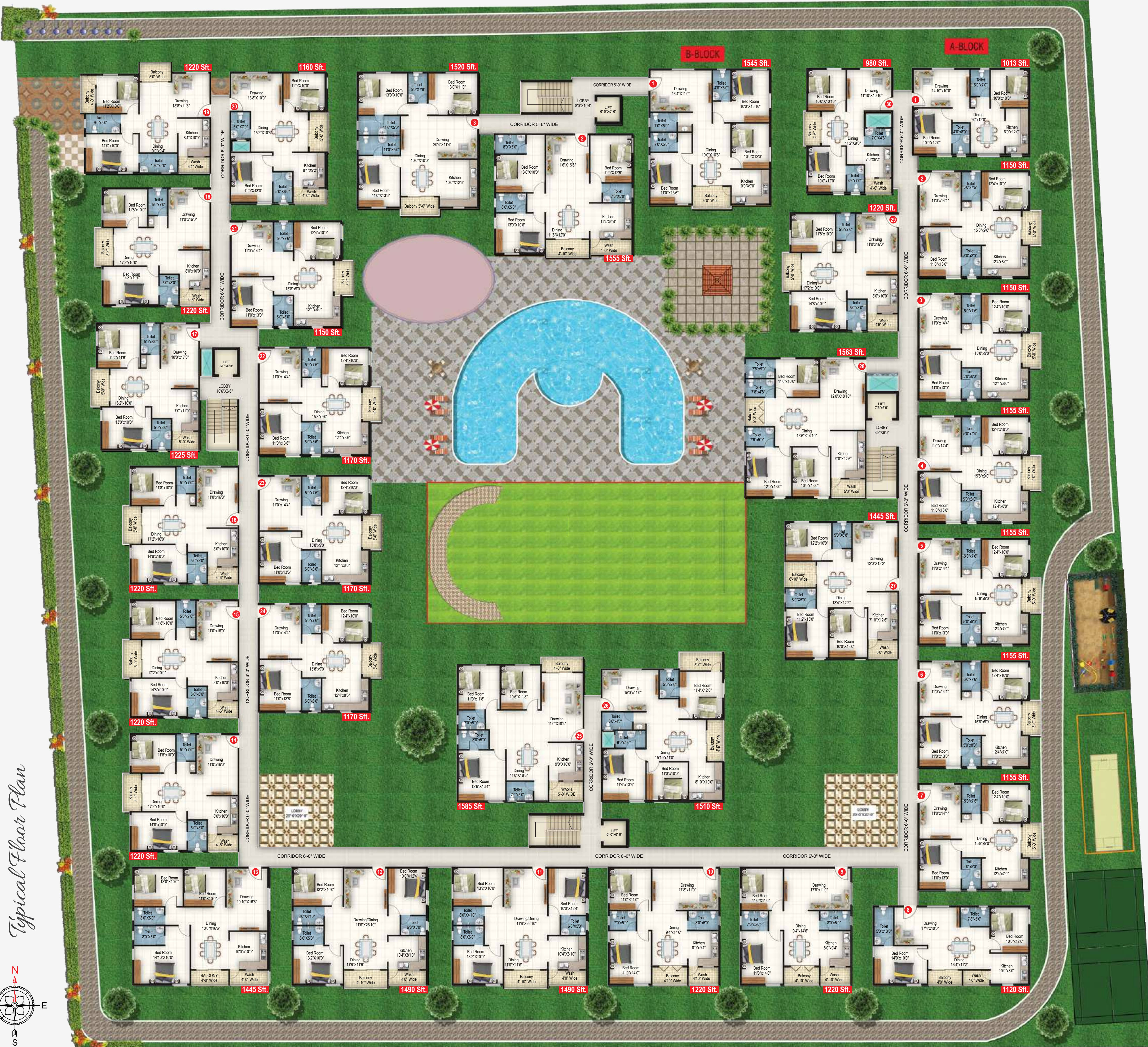
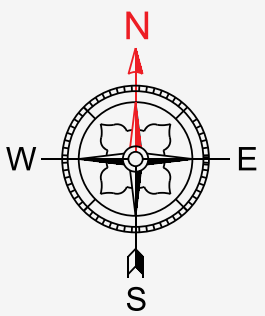



*A plan to elevate your  
happiness*

The entire project is meticulously designed down to the final detail. The place is well-demarcated to offer views of green and drink in the nature's beauty. The plan is to revitalize lives with lots of sunlight and oodles of fresh air. The reason why the center of the project boasts of amphi-theatre, skating rink, swimming pool, offering comfortably access to all the residents.



2 BHK 3D VIEW  
FLAT No. 19 (East Facing)

- 1) Drawing
- 2) Dining
- 3) Kitchen
- 4) Wash Area
- 5) A. Toilet
- 6) M. Bed Room
- 7) C. Toilet
- 8) Balcony
- 9) Ch. Bed Room
- 10) Balcony



- 1) Drawing
- 2) Ch. Bed Room
- 3) Balcony
- 4) Dining
- 5) Kitchen
- 6) Wash Area
- 7) A. Toilet
- 8) M. Bed Room
- 9) C. Toilet

2 BHK 3D VIEW  
FLAT No. 20 (West Facing)

3 BHK 3D VIEW  
FLAT No. 25 (East Facing)

- 1) Drawing
- 2) Kitchen
- 3) Wash Area
- 4) C. Toilet
- 5) Dining
- 6) M. Bed Room
- 7) A. Toilet
- 8) A. Toilet
- 9) Ch. Bed Room
- 10) G. Bed Room
- 11) Balcony





#### OUTDOOR

- Swimming Pool with Toddler's pool/ Kid's Pool
- Jogging Track
- Badminton Court
- Basketball Post.
- Cricket practice pitch.
- Amphitheatre.
- Senior Citizen Hub.
- Skating Rink

#### INDOOR

- Club House Party Hall
- Indoor Games Like Billiards/ Snooker, Table Tennis etc.
- Children's Activity Center/ Fun and Frolic zone.
- Well Balanced Gymnasium.

#### SECURITY FEATURES

- CCTV Surveillance at the entrance and exit.
- Intercom for all the flats.
- 24 Hours Security.

#### SERVICES

- Rain Water Harvesting.
- Generator Backup.





## SPECIFICATIONS



### STRUCTURE

R.C.C framed structure suitable to withstand wind & seismic loads.



### SUPER STRUCTURE

Porotherm blocks for external walls of 6" thick & internal walls of 4" thick.



### DOORS AND WINDOWS

- Main door: Teak wood frames and solid core flush door shutter with aesthetically designed veneer with melamine polish and brass hardware of reputed make.
- Internal doors: Sal wood frames with flush door shutters with both side laminated fitted with SS coated hardware of reputed make.
- Windows: Three track UPVC windows with two sliding shutters fitted with glass, one shutter fitted with mosquito mesh and safety grills for living, bed rooms and kitchen.



### PAINTING

- Exterior: two coats of exterior emulsion paint on one coat of exterior wall primer.
- Interior: Smooth finish with luppam or equivalent material over a coat of wall primer and top finish with two coats tractor emulsion.
- M/S Grills: Two coats of enamel paint over base coat zinc oxide primer.



### FLOORING

- Vitrified tiles with 4" height skirting for living hall, bed rooms, dining and kitchen.
- Anti skid ceramic tiles flooring for toilets and utility areas with 7' height ceramic tile dado.



### SANITARY WARES

EWC with flush tank of Hindware or equivalent make in all toilets.

# SSVR Acacia

Live with nature



### WATER SUPPLY

24 hour water supply from bore wells, over head tanks and water sumps.



### CP FITTINGS

All CP fittings are of Jaguar or equivalent make.



### ELECTRICAL WORKS

Concealed copper wiring through PVC conduit pipes for internal works of standard make. Adequate electrical points required for living, dining, bedroom, kitchen, bath rooms are provided. Branded make switches and fittings are provided.



### INTERCOM

All houses are interconnected and also with the security.



### LIFTS

4 lifts of 6 (six) passenger capacity of Johnson or equivalent make.



### POWER BACK UP

Back up power through acoustic power generator for services and common areas lighting.



### CAR PARKING

Exclusive Covered car parking

## LOCATION HIGHLIGHTS

- Intel
- Accenture
- CISCO
- Wipro
- Embassy Tech Village
- Cessna Business Park
- J.P. Morgan
- Gear International School
- Delhi Public School
- VIBGYOR School
- New Horizon Engineering College
- Geethanjali Olympiad School
- New Horizon Gurukul
- Kripanidhi College
- New Horizon Vidya Mandir
- VIMS Hospital
- SAKRA World Hospital
- Rainbow Children Hospital
- Central Mall
- More Mega Mart
- Total Mall
- Home Town
- Novotel
- Passport Office
- Maruth Showroom
- Toyota Showroom
- Hyundai Showroom

## LOCATION MAP (NOT TO SCALE)

